

EHD IMAGING GMBH

Digital Focuser DF-2

*Digital Focuser with 0.20" travel , optimized for CCD-Astronomy
or optical research.*



EHD IMAGING GMBH

Zum Rennplatz 15
D-49401 Damme

Telefon: 05491/2090
Fax: 05491/2098
E-Mail: info@ehd.de

Design: There are three lead screws that set the distance between two parallel plates. The plates are bored and threaded to receive the camera and mounting adapters. The three lead screws are driven simultaneously, thus moving the plates closer or further apart. The lead screws are double-ended, having both left and right hand threads. The plates are tapped to match. Light shields are included along with a motor mount, cover, and electrical connections. The closely fitted pins and journals prevent rotation or lateral shift between the plates. Finally, three stages of reduction are employed for high mechanical advantage and extreme resolution.

Other critical elements incorporated into our design include rotational symmetry to enhance stability and strict attention to kinematics. Accurate machining is employed, using CNC equipment to achieve consistent, ultra smooth operating characteristics. Precision grade components ensure that lead screws turn exactly in phase. Each integral DF-2 component is specified for the lowest possible wear and minimal maintenance under extreme environmental conditions.

- Computer Controlled
- Support for Auto-Focussing
- USB Interface
- 0.0001"/Step Resolution
- 0.20" Travel
- 1.9" Clear Aperture
- Minimum Thickness of 0.77" with MaxCam or IMG-Series
- DF-2 Weight is 2 lbs.

Dimensions

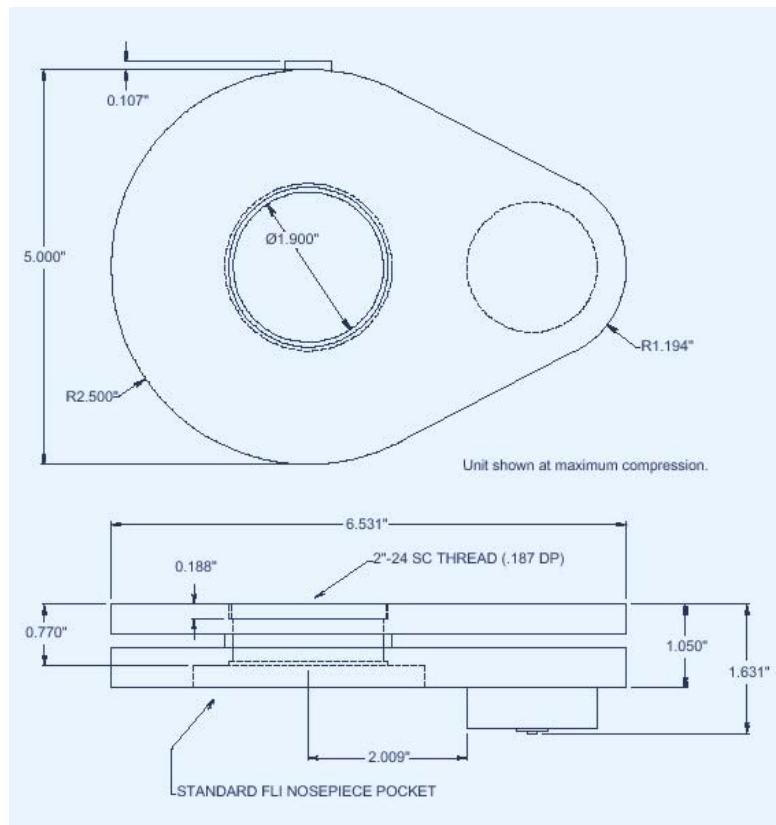

DF-2 with Universal-Adapter

