

CCD Camera



Data Sheet

UK1117 - M **VGA monochrome**
UK1117 - C **VGA color**

The UK1117 Mini Camera is a compact CCD camera designed for industrial and scientific image processing tasks. The camera is part of the EHD CCD camera family with different features for various applications. Typical fields of application for this VGA camera are high resolution measurement, microscopy, documentation and surveillance.

The color sensor with *Wfine* CCD[®] technology provides high signal-to-noise ratio even at poor lighting conditions. The global shutter allows image capture of fast moving objects. The optional opto-decoupled digital outputs and opto-decoupled digital inputs are advantageous in order to use the camera under rough conditions. The camera can control flashlight illumination. The small body allows assembly flexibility in cases with little space in machines or facilities. The camera is available as color or monochrome version.

If necessary the camera itself can trigger flash lights.

The global shutter of the UK1117 camera is a special feature which provides the capability of capturing images of very fast moving objects.

The fast USB2.0 interface allows the transmission of a maximum of 50 noncompressed live images per second at full sensor resolution. Thus the user has the possibility to implement image processing applications without using an additional frame grabber. With the integrated high performance DSP developers may realize image processing or image pre-processing tasks directly in the camera. Thus the camera can be used as a stand-alone intelligent optical sensor.

The built-in memory is able to save up to 20 images and provides the possibility to decouple image capturing and transmission.

Pixel resolution	768 × 576 Pixel (PAL) 640 × 480 Pixel (VGA), (color sensor with <i>Wfine</i> CCD [®])
CCD sensor	1/2"
Frame rate (sensor)	50 fps
Shutter	global shutter
Exposure time	50 μs bis 80 s
Pixel size	8,3 μm × 8,3 μm
A/D resolution	12 Bit
Data interface	high-speed USB2.0
Processor	built-in DSP
Image memory	32 Mbyte
Power supply	USB bus powered
Dimensions	31 mm × 45 mm × 50 mm
Lens mounting	C-mount



Wfine CCD is trademark of Sony corporation.

design and specification may change without notice

UK1117_Datasheet_V104 Seite 1/2

EHD imaging GmbH

Zum Rennplatz 15
D-49401 Damme

Tel.: +49-5491-2090
Fax: +49-5491-2098
info@ehd.dd
www.ehd.de

Technical Specifications

Sensor	1/2" CCD progressive scan, monochrome 1/2" CCD progressive scan, color, BAYER pattern
Resolution	768 × 576 Pixel (PAL), 640 × 480 Pixel (VGA)
Pixel size	8,3 µm × 8,3 µm
Lens mounting	C-mount
Frame rate	50 fps at 768 × 576
Electronic shutter	global shutter
Exposure time	50 µs to 80 s
Built-in memory	32 MByte
DSP power	1200 MMAC
Digital inputs*	2× opto-decoupled input (freely programmable) 1× fast TTL trigger input
Digital outputs*	2× opto-decoupled output (programmable as strobe)
HOST interface	USB2.0 (mini-USB plug)
Power supply (camera)	USB bus powered
Power loss	typically 2,2 W
Temperature range (operational)	0°C to 55°C
Temperature range (store)	-20°C to +70°C
Dimensions	31 mm × 45 mm × 50 mm
Weight	80 g (without lens)

optional

Dimensions

Frontansicht

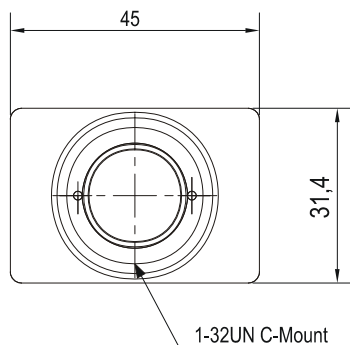

Seitenansicht

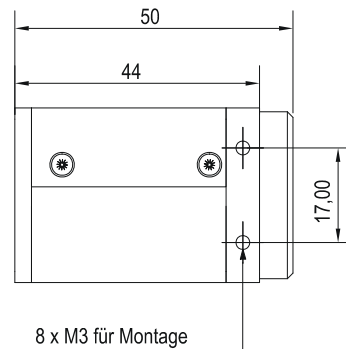

Oben

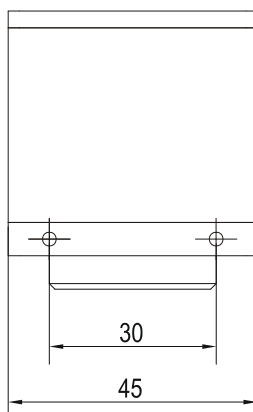

Rückansicht

